

Rimarplast

WATERSTOP - BUILDING JOINTS

CHARACTERISTICS

Rimarplast Waterstops are high quality pvc joints whose mechanical and elastic properties guarantee excellent performances.

Their specifications are maintained in the long term even at low temperatures (from -30°C up to +60°C).

They do not require special warehousing or conditions.

They resist to ageing and to chemical attack in alkaline environments but also to brackish water or acid solutions.

They are designed to resist to the high stresses the building is subjected to during settlement.

The welding either with hot air or heated blades can be carried out on site.

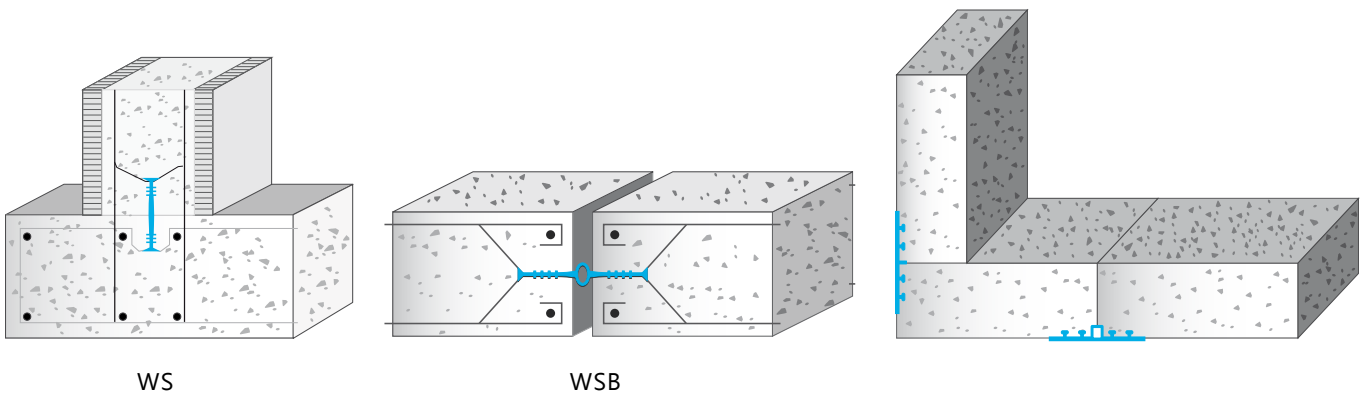

TECHNICAL FEATURES	UNIT OF MEASURE	VALUES	TEST METHOD
HARDNESS	Sh A 15"	70 /75 ± 2	ISO 868
SPECIFIC WEIGTH	g/cm 3	1.40 ± 0.03	ISO 1183
TENSILE STRENGTH AT BREAK	N/mm2	12 ± 2	ISO 527
ELONGATION AT BREAK	%	250 ± 25	ISO 527
STIFFNESS TEMPERATURE	C°	-25± 5	ISO 458/2
INFIAMMABILITY	Classe	V0	UL 94
OILS RESISTANCE	Normal resistance in case of contact of short duration not suitable to immersions of long duration. In this case it is necessary to use a specific type of PVC for the purpose.		
All data and information reported here are the result of our laboratory tests on samples without any colour. They have to be considered indicative datas which are not guarantee. Our technical department is at your disposal for any further information.			

ON DEMAND IT IS POSSIBLE TO HAVE CUSTOMISE PROPRIETIES

TYPES OF STRESS			
WS :	Hydrostatic Pressure < 0,5 atm	Longitudinal Stress < 10 mm	Tranverse Stress < 5 mm
WSB-WSE-WSBE :	Hydr. Pressure > 1-2 atm	Long. Stress. > 10-20 mm	Tranv. Stress >5-10 mm



WATERSTOP SERIES

WS and WSE

WATERSTOP FOR CONNECTING CONCRETE CASTINGS

Casting joints between fresh and hardened concrete always represents a structural interlude which water leaks can develop. Rimarplast WS joints in PVC are suitable for casting joints which are not subject to movement.

The most important advantages are:

- 1 - The excellent watertight seal, even when pressures occur (suitable both for high and low stratum).
The watertight is guaranteed by a static barrier which is able to absorb the water-level fluctuations of the stratum.
- 2 - No particular conditions required for the concrete (i.e. clean or smooth surface) being the joints drowned in the concrete.
- 3 - No special requirements for warehousing before laying.

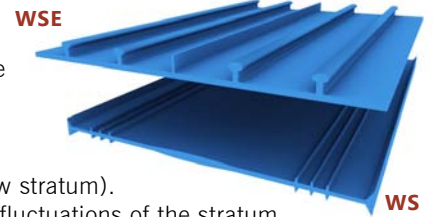

WSB and WSBE

WATERSTOP FOR EXPANSION JOINTS

Waterstops for expansion joints have the dual function of absorbing this movement in predetermined points of the structure to avoid the formation of cracks or fissures in adjacent areas and also acts as a barrier to ensure water, air and foreign bodies do not penetrate the interstice. Structures in contact with water or dampness must be designed and built with the utmost care in order to guarantee watertight seal. The most reliable technology to achieve this aim is by laying Pvc Waterstop WSB with central bulb in the middle of the thickness of the concrete.

In the case of expansion joints for outdoor laying the type to employ is WSBE, where one side is drowned in the concrete and the other is on the outside surface. A central bulb ensures also in this case the absorption of the movements.

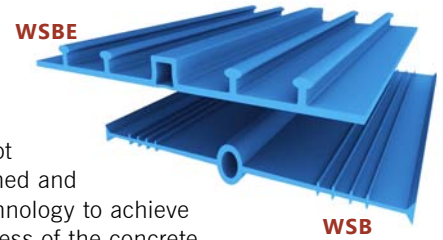

CODE	A(mm)	B(mm)	PACKAGING (m)
WS 150	150 mm	2,0 mm	RT. 50 m
WS 180	180 mm	2,5 mm	RT. 50 m
WS 200	200 mm	2,5 mm	RT. 50 m
WS 215	215 mm	3,0 mm	RT. 50 m
WS 250	250 mm	3,0 mm	RT. 25 m
WS 300	300 mm	3,0 mm	RT. 25 m

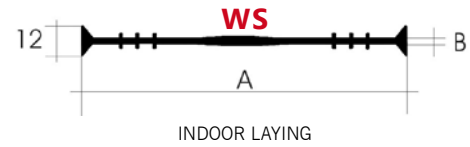

CODE	A(mm)	B(mm)	PACKAGING (m)
WSE 200	200 mm	16 mm	RT. 20 m
WSE 250	250 mm	16 mm	RT. 15 m

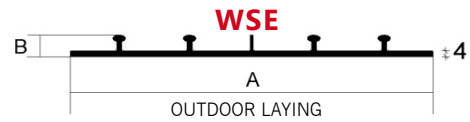

CODE	A(mm)	B(mm)	PACKAGING (m)
WSB 180	180 mm	2,5 mm	RT. 25 m
WSB 200	200 mm	2,5 mm	RT. 25 m
WSB 220	220 mm	3,0 mm	RT. 25 m
WSB 250	250 mm	3,5 mm	RT. 20 m
WSB 300	300 mm	3,5 mm	RT. 20 m
WSB 320	320 mm	3,5 mm	RT. 15 m
WSB 350	350 mm	4,0 mm	RT. 15 m
WSB 360	360 mm	4,2 mm	RT. 15 m
WSB 440	440 mm	4,5 mm	RT. 12,5 m

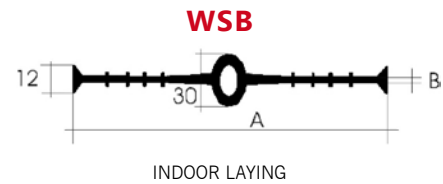

CODE	A(mm)	B(mm)	PACKAGING (m)
WSBIQ 200	200 mm	4 mm	RT. 25 m
WSBIQ 250	250 mm	5 mm	RT. 20 m

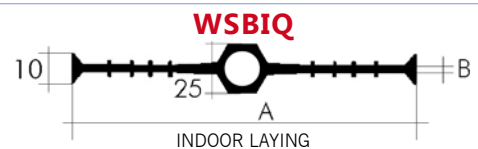

CODE	A(mm)	B(mm)	PACKAGING (m)
WSBE 200	200 mm	17 mm	RT. 20 m
WSBE 250	250 mm	18 mm	RT. 15 m



ISTRUCTIONS FOR LAYING

WS and WSB

WS and WSB joints must be drowned in the concrete and set in the middle. They have to be properly secured to the framework by clips or wires to ensure a certain stability during casting and to avoid the formation of folds. With WS the two castings have to be in touch.

With WSB concrete castings cast at different times feature a cavity equal to the width of the bulb and the cavity must be filled with a suitable elastic material.

WSE and WSBE

WSE and WSBE are used for outdoor laying castings.

They are fixed directly on the bed of the structure.

The side not flat is drowned in the concrete, the central winglet ensures the proper position in the middle.

WELDING

IMPORTANT: It is advised to have care to vibrate the casting near the joint, in order to avoid the creation of the so called gravel nests.

All Waterstops can be welded on site by two devices:

- The hot blade («thermal sword») is used to make special “L”, “T” or cross couplings by inserting the hot blade between the edges for 15/20 seconds at 150°/180°C.
- The electronic hot air blow pipe is employed on the two edges to weld for 15/20 seconds at 400-600 °C.



CAUTIONS :

- The edges of the joint must be perfectly squared off.
- Keep them in touch with the heat source until the two pieces are both melt.
- Check the welding is uniform on the whole surface.

Wear mask and protective gloves

WALL APPLICATIONS

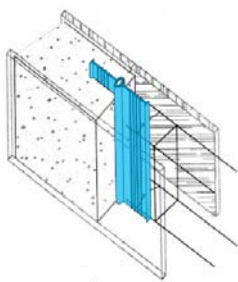

WSB: Vertical casting

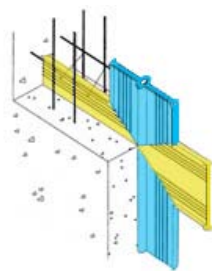

WSB: Horizontal and vertical connecting casting

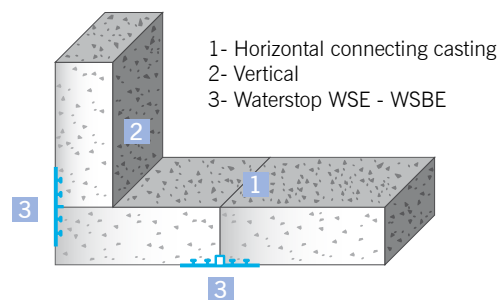

WSE - WSBE: Horizontal and vertical connecting casting



WATERSTOP

Rimarplast supplies a wide range of products for connecting concrete castings.

For over 20 years we are operating in the building market with a wide range of pvc joints that can be used in concrete structures.

They ensure watertight seal both for connecting concrete castings and for expansion joints.

The various types of Watertops available include the range WS and WSB, which have to be drowned in the middle of the thickness of the castings, and the range «flat» WSE and WSBE which are for outdoor laying.

WSE and WSBE



WS and WSB



WSBIQ

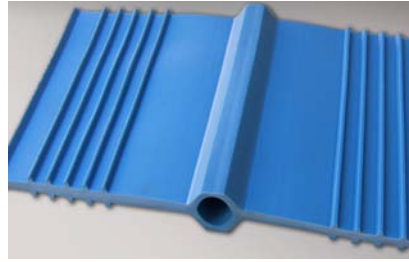

They are used to contain water and to protect from infiltrations :

- Swimming Pools
- Channels
- Tanks Basements
- Dams
- Aqueducts
- Tunnels
- Foundations



STORAGE

Stock in a dry place at a temperature of between +10°C and +40°C.

SAFETY INSTRUCTIONS FOR PREPARATION AND APPLICATION

Our Waterstop in PVC are articles and referring to the current European regulations (Reg. 1906/2007/CE-REACH) do not require the preparation of the material Safety Data Sheet. During use it is recommended to wear protective gloves and goggles and follow the safety requirements of the workplace.

PRODUCT FOR PROFESSIONAL USE.

WARNING

All the above technical details and recommendations must be taken as indicative and subject to confirmation after long-term application. For this reason anyone who intends to use the product must ensure that it is suitable for the application and take responsibility for any consequences deriving from the use of the product.

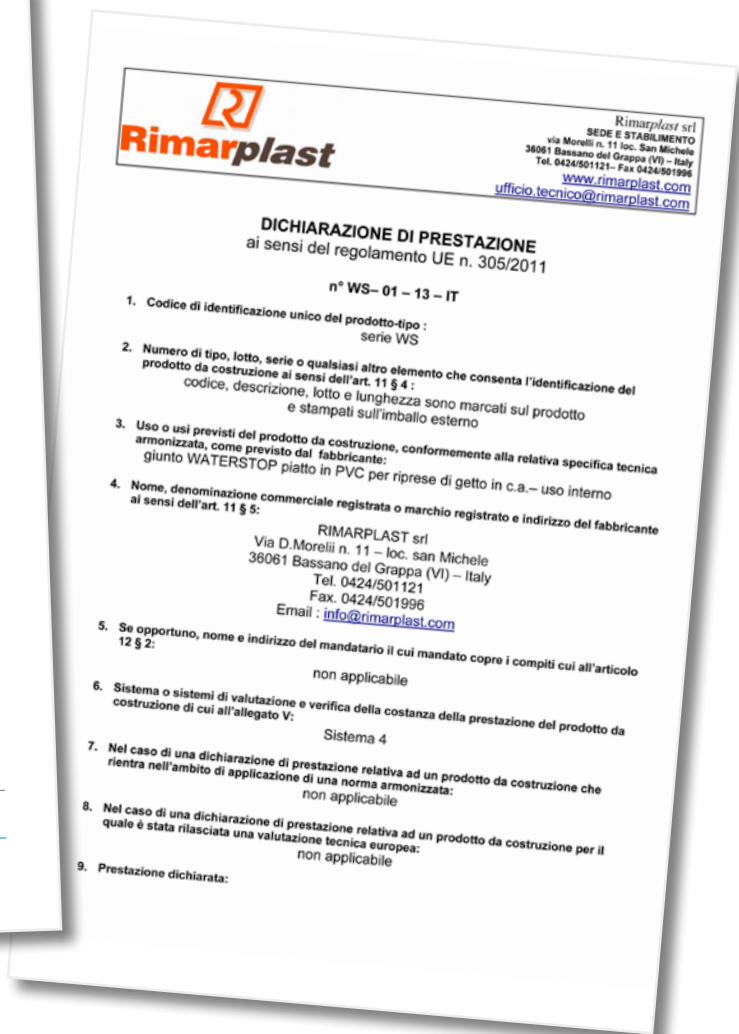

RIMARPLAST srl

Via IV Novembre 42/A- Loc. Campese

36061 Bassano del Grappa (VI) Italy

phone. (+39) 0424 501121 fax. (+39) 0424 501996

web site: www.rimarplast.com - email: info@rimarplast.com

